

2012

VMZINC Ornaments

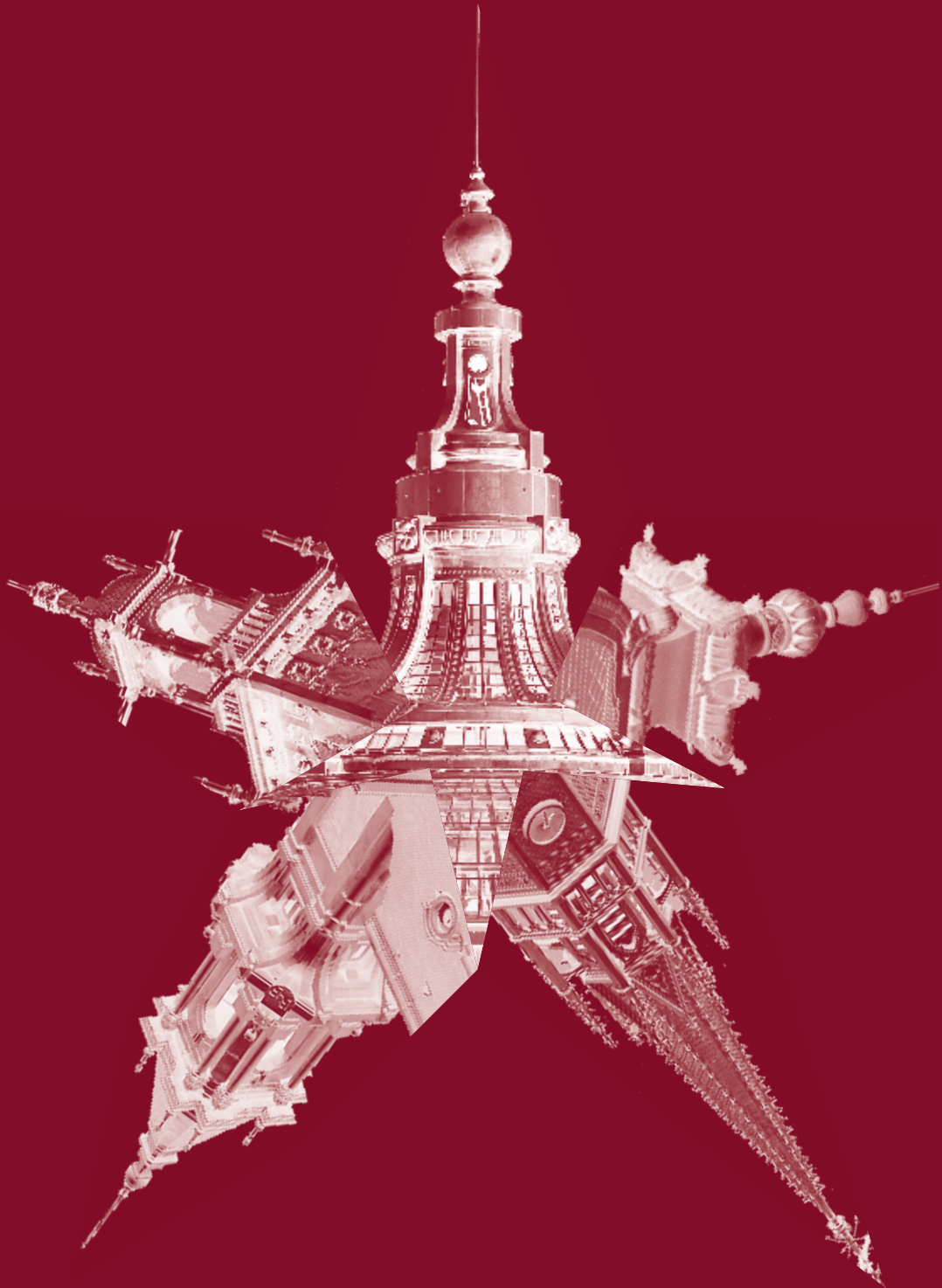

VMZINC Ornaments

Contents

Tradition and service	5
Heirs of an artistic craft	
Unique know-how	



LARGE PROJECTS

Domes, bell towers, steeples and kiosks	9
--	----------

BULL'S EYE WINDOWS AND DORMER WINDOWS

Bull's eye windows and dormer windows	13
Referenced Bull's eye Windows	20
Referenced dormer windows	23

SMOOTH AND STAMPED PROFILES

Smooth and stamped profiles	25
Straight smooth profiles	28
Referenced curb members	
Referenced gutter fronts	
Referenced cover strips	
Smooth curved profiles	31
Referenced stamped profiles	32
Curb members	
Gutter fronts - Escutcheons	

STAMPED MOTIFS

Stamped motifs	33
Referenced double ridge caps	
Referenced stamped motifs	40
Canopies	
Scallops	
Ropes, hip capping, beads	
Rosettes	

OTHER PRODUCTS

Other products	43
Referenced scale panels	
Referenced rainwater downpipes	



Tradition and service

Heirs of an artistic craft

The Haussmann-style buildings and Universal Expositions of the 19th century left an extraordinary architectural heritage.



In ancient times, the Greeks and Romans were already decorating the tiled roofs of their houses with terracotta motifs. In the 12th and 13th centuries, metal flashings on roofs became more sophisticated as slopes became steeper and started to be used as decorations to embellish roofs. Finials, crests and gutters were used to identify the owners of stately or religious residences.



But it wasn't until the 19th century that metal decorations were used on all types of buildings. As roofers started using rolled zinc and the Grados establishments improved the use of zinc in stamping, craftsmen of the time were provided a new means of artistic expression.

Hip caps and gutter fronts were embossed, curved edges were decorated with mouldings, ova and rings, and canopies became sculptural. Metal slowly began to replace stone on roofs. Technical achievements elevated metal ornaments to a new level and created enormous growth.



Tradition and service

Heirs of an artistic craft



The Ateliers d'Art Français have been manufacturing zinc and copper roof ornaments for over 150 years. This prestigious range is now marketed under the VMZINC® brand.

In chapter one, you will also see a short range of roof ornaments providing excellent value for money thanks to the combination of VMZINC expertise in roofing products and the know-how of our ornamental metal workers.

VMZINC's vocation is to perpetuate the roof ornaments tradition and to pass on to future generations a unique artistic craft in which Ateliers d'Art Français is today the leader. Over the years, the Ateliers d'Art Français have collected old catalogues, architectural drawings and stamping moulds making it possible to produce replicas of period pieces and thus contribute to the conservation of an ancient heritage.



Each new project is a challenge. The ornamental metal worker tries and tries again, devotes the time necessary to recreate or reinvent an ancient decor, to define its exact shape, finely remodel it and adapt it to suit a new framework.



Tradition and service

Unique know-how



Metal ornamentation is more than a profession, it requires know-how that has been passed directly from experienced ornamental metal workers to apprentices for more than 150 years. True to the tradition of skilled crafts, the apprentice inherits an ancient tradition through contact with seasoned ornamental metal workers and day to day experience.

It takes five to seven years to master sheet metal work to produce complex decorative pieces. In addition to precision forming and soldering, the apprentice must acquire complementary skills in areas such as stamping, foundry and sheet metal work.

These unique skills are used to renovate roofs decorated with dormer windows, bull's-eye windows, bell towers, domes and finials that all bear witness to the extraordinary ornamental metal work of the 19th century.



Reproduction of ancient decors using original models

Although they are exclusively hand-made, all ornaments produced by VMZINC are drawn to scale 1 before being reproduced. This reparative work makes it possible to better reproduce details, achieve greater precision in assemblies and produce perfectly identical series.



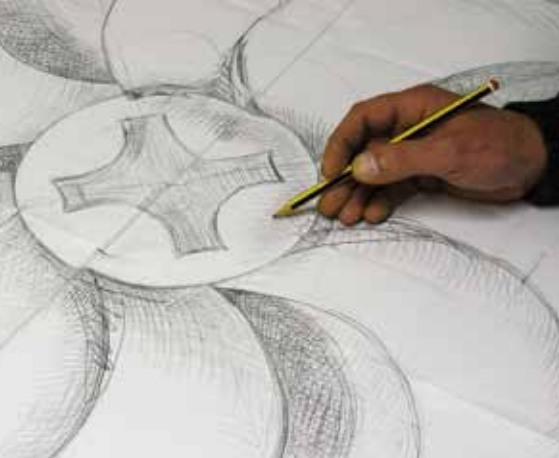

Tradition and service

Unique know-how



Creation of decors based on engravings, photographs or detailed sketches

The ornamental metal worker may have to restore or even recreate certain parts missing from an ornament that may have been damaged over the years by drawing inspiration from period documents.

The service quality of a large group

VMZINC is the international brand of Umicore Group for rolled zinc products. As part of an industrial group specialising in non-ferrous metals it offers the best guarantee of service quality and a high level of commitment.

A benchmark for the market

Our ornamental metal workers possess a perfect command of all the production stages and provide assemblies with a high standard of finish, regularity and extremely refined details for stamped decors. The quality of work produced by our workshops is a benchmark for all professionals working on roof renovation projects with ornaments.



Sharing ancient decors

Ateliers d'Art Français offers a range comprising over 300 referenced decors, some of which were originally created more than a century ago. These are divided into six main categories:

- Dormer and bull's-eye windows,
- Finials, pinnacles and pennants,
- Weather vanes and compositions,
- Flat and stamped profiles,
- Stamped motifs,
- Stamped scaled panels and decorative downpipes.

The entire range is available in rolled zinc and copper.

DOMES, BELL TOWERS, STEEPLES AND KIOSKS

Their majestic outlines are landmarks in our large towns and cities. Their cladding is made up of a series of superimposed decors. These masterpieces are the jewel in the crown of the “Ateliers d’Art Français” and require perfect mastery of all metal transforming skills, necessitating up to 3 different alloys for zinc decorations. Some pieces, especially new creations, may require several months of research before the first elements can be formed.



Domes, bell towers, steeples and kiosks



Hotel, Cannes, France



Château de Madrid, Neuilly-sur-Seine, France



Theatre, Quimper, France

Domes, bell towers, steeples and kiosks



Town Hall, Corbeil-Essonne, France



Town Hall, Montluçon, France



Avenue Montaigne, Paris, France

Domes, bell towers, steeples and kiosks



Kiosk, London, England



Vitry-le-François, France



Grand Palais, Paris, France

BULL'S EYE WINDOWS AND DORMER WINDOWS

Although bull's eye windows and dormer windows appeared around the 18th century to ventilate high roofs, it was not until the 19th century that they became widespread, especially in towns where attics were converted.

Bull's eye windows and dormer windows come in various styles and shapes and embellish the majestic beauty of roofs of period residences and prestigious buildings.

Thanks to their command of zinc and copper work, our ornamental metal workers can reproduce these ornaments in series.



Bull's eye windows and dormer windows



Boulevard Haussman, Paris, France *



* Made to order model

Theatre, Quimper, France

Bull's eye windows and dormer windows



Town Hall, Corbeil-en-Gatinais, France *



Anncy, France *

* Made to order model

Bull's eye windows and dormer windows



Regional Court, Montpellier, France *



Honfleur, France *



Department Store, Paris, France *



Boulevard des Capucines, Paris, France *

* Made to order model

Bull's eye windows and dormer windows



Town Hall, Corbeil-en-Gatinais, France *



Town Hall, Corbeil Essonnes, France *

* Made to order model

Bull's eye windows and dormer windows



Copper dormer windows, Belgium *



Avenue du Président Wilson, Paris, France *

* Made to order model

Bull's eye windows and dormer windows



Avenue Georges Mandel, Paris, France *



Rue de Téhéran, Paris, France *



Vuaz-en-Sallaz, France *

* Made to order model



Referenced Bull's eye Windows

All our referenced bull's eye windows are supplied for facades or with slopes and flanges. This range is available in defined dimensions and styles in natural zinc, QUARTZ-ZINC®, ANTHRA-ZINC® and copper. The models presented are intended for new buildings. Use in renovations may require modifications to the building structure (contact us).



Reference	Opening in m	Overall length in m		Mounted key	Existing joinery p. 21
		Height	Width		
3020 and 3021*	0.60 x 0.40	0.97	0.95	2281/028	
	0.65 x 0.50	1.04	1.06	2282/040	■
	0.70 x 0.50	1.13	1.16	2282/040	
	0.80 x 0.60	1.29	1.31	2282/040	■
	0.90 x 0.60	1.40	1.31	2282/040	■
3022	0.60 x 0.40	0.96	1.00	-	■
	0.65 x 0.50	1.03	1.12	-	■
	0.70 x 0.50	1.08	1.12	-	■
	0.80 x 0.60	1.21	1.27	-	■
3023	Ø 0.75	1.23	1.27	-	
3024 and 3025*	0.50 x 0.40	0.95	0.78	0605/032	■
	0.65 x 0.50	1.18	1.00	0605/032	■
	0.70 x 0.50	1.23	1.00	0605/032	■
	0.80 x 0.60	1.38	1.10	2282/040	■
3026	Ø 0.75	1.18	1.28	-	
3065	Ø 0.25	0.46	0.46	-	
3066	Ø 0.35	0.86	0.86	-	
	Ø 0.40	0.98	0.98	-	
	Ø 0.45	1.02	1.02	-	
	Ø 0.50	1.07	1.07	-	■
	Ø 0.60	1.23	1.23	-	■
3067	0.65 x 0.50	1.20	1.10	-	■
	0.70 x 0.55	1.20	1.10	-	■
	0.80 x 0.60	1.35	1.23	-	■
	0.90 x 0.60	1.47	1.23	-	■
4205	Ø 0.25	0.49	0.54	-	
	Ø 0.28	0.53	0.58	-	
	Ø 0.32	0.57	0.62	-	
	Ø 0.38	0.69	0.74	-	
	Ø 0.60	1.07	1.16	-	■
4206	0.45 x 0.32	0.74	0.72	-	■
	0.65 x 0.50	1.07	1.11	-	■
	0.70 x 0.50	1.12	1.11	-	■
	0.80 x 0.60	1.20	1.32	-	■
4211	Ø 0.50	1.08	1.16	-	■
	Ø 0.60	1.30	1.39	-	■
	Ø 0.75	1.52	1.65	-	■
	Ø 0.90	1.94	2.08	-	■

*: identical to previous model without frontal key

Wood frames

Wood frames in red exotic wood, with casement, 24 mm double glazing (4/16/4), thickness 46 mm:

- with watertight joint installed on casement for vertical opening,
- with double watertight joint for pivot opening.

Dimensions in cm	
Reveal	Overall
Ø 50	Ø 58
Ø 60	Ø 68
Ø 90	Ø 98
65 x 50	73 x 58
80 x 60	88 x 68
90 x 60	98 x 68

Optional: fixed and small wooden frames for 4 panes.

N.B.
Wood frames are designed to be fixed on the substructure of the bull's eye window, not on the interior (see drawing below).



Installation of wood frame

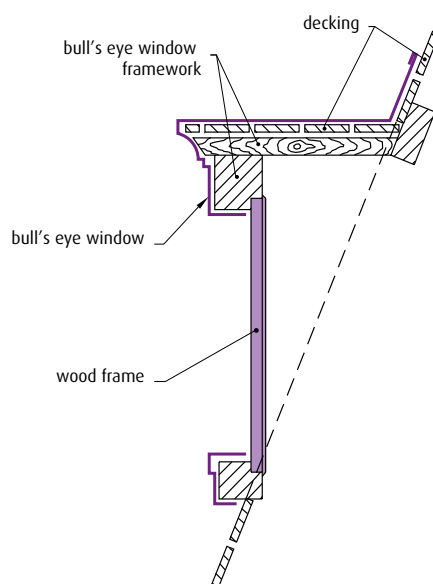

Quotation request for bull's eye window

You must attach a good quality photo to your request showing as many details as possible.

Information about the site

Site reference:.....
 Company name:.....
 Company telephone:.....

Return of model requested with the order

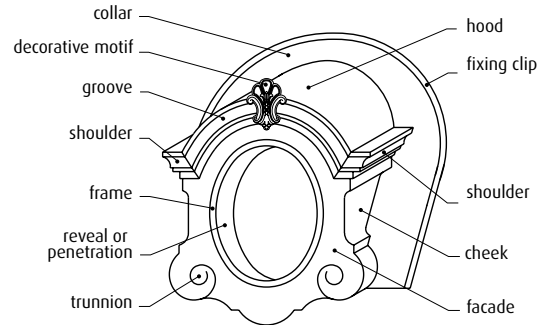

Information about bull's eye window

Quantity:.....

Metal:

- Natural zinc
- ANTHRA-ZINC®
- QUARTZ-ZINC®
- Natural copper

Material:

- Slate
- Metal
- Tile
- Others (specify):

Bull's eye windows in catalogue (specify the ref.):

Model reproduction

Adjustment to slope:

- Straight slope (specify dimension A):
- Curved roof
- Dome
- Facade only

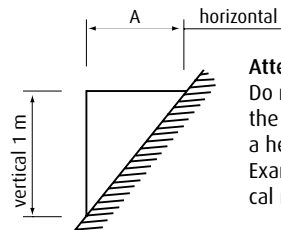

Attention: Dimension A
 Do not give degree or percentage for the slope. Give horizontal length A for a height of 1 m.
 Example: length of 0.4 m for 1 vertical meter.

Dimensions to be provided (mm)

- Length of hood (B) :
- Width of opening (C) :
- Height of opening (D) :
- Overall width (E) :
- Overall height (F) :

Side view

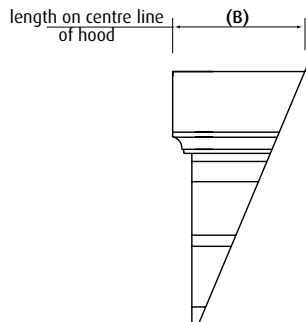

Front view

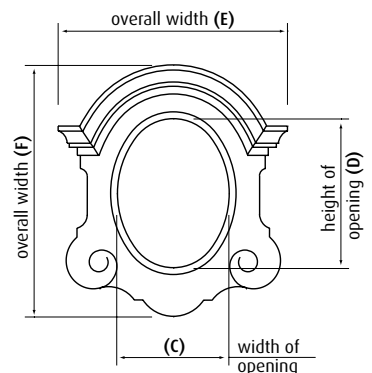



4203

Referenced dormer windows

All our referenced dormer windows are supplied for facades or with slopes and flanges. This range is available in defined dimensions and styles in natural zinc, QUARTZ-ZINC®, ANTHRA-ZINC® and copper. The models presented are intended for new buildings. Use in renovations may require modifications to the building structure (contact us).

Reference	Opening in m	Overall dimensions in m		Mounted key
		Height	Width	
3005	1.40 x 0.80	2.03	1.47	-
	1.60 x 0.95	2.34	1.71	-
3011	0.90 x 0.55	1.50	1.22	-
	0.90 x 0.70	1.50	1.37	-
	1.20 x 0.80	1.88	1.58	-
3012	0.90 x 0.55	1.36	1.17	-
3015	0.90 x 0.60	1.46	1.08	-
	1.00 x 0.75	1.68	1.38	-
	1.20 x 0.95	2.00	1.68	-
	1.40 x 1.15	2.24	1.88	-
3460	1.00 x 0.60	1.34	1.08	-
3494	1.00 x 0.60	1.69	1.22	Ø 160 mm ball
	1.30 x 0.75	2.09	1.48	Ø 160 mm ball
4203	0.75 x 0.46	1.12	1.04	4411 / 029
	0.90 x 0.55	1.33	1.16	2282 / 040
4204	0.75 x 0.46	1.06	1.04	-
	0.90 x 0.55	1.27	1.17	-

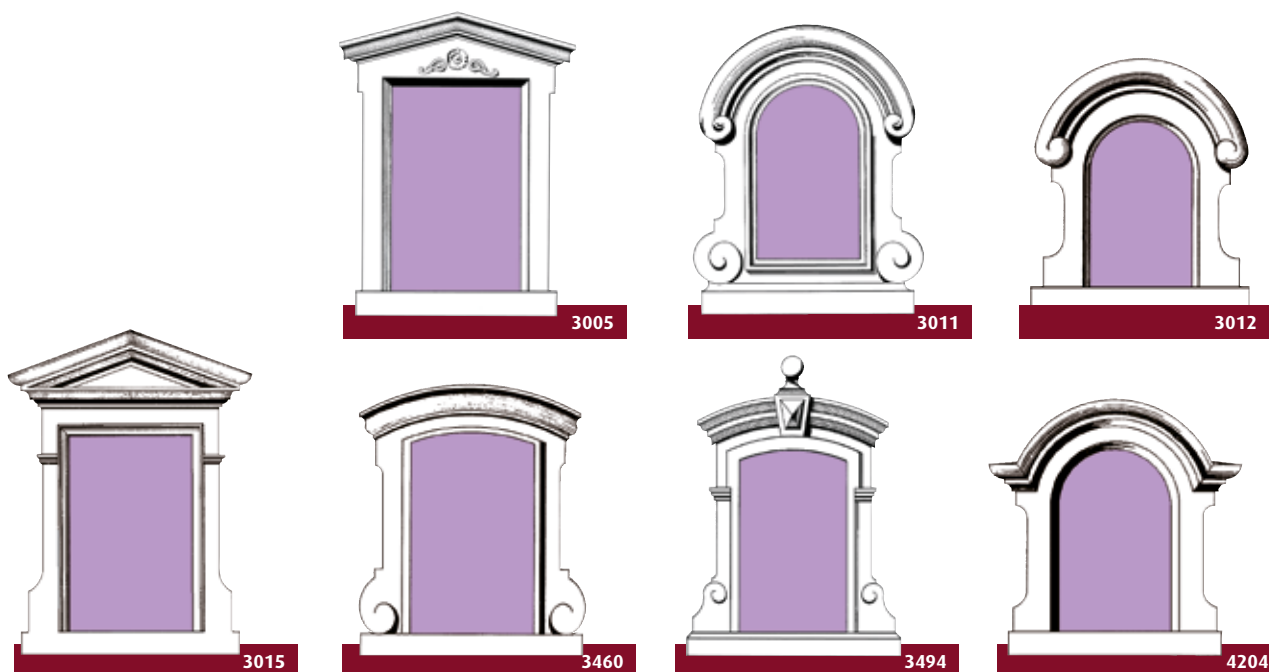

Quotation request for dormer windows

You must attach a good quality photo to your request showing as many details as possible.

■ Information about the site

Site reference:.....

Company name:.....

Company telephone:.....

Return of model requested with the order

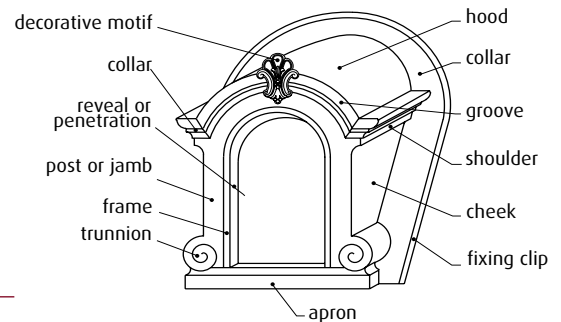

■ Information about dormer window

Quantity:.....

Metal:

- Natural zinc QUARTZ-ZINC®
 ANTHRA-ZINC® Natural copper

Material:

- Slate
 Metal
 Tile
 Others (specify):

Dormer windows in catalogue (specify the ref.):

Model reproduction

Adjustment to slope:

- Straight slope (specify dimension A):
 Curved roof
 Dome
 Facade only

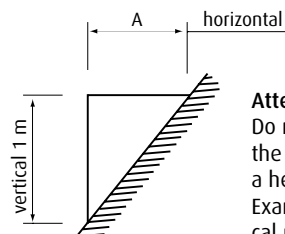

Attention: Dimension A
 Do not give degree or percentage for the slope. Give horizontal length A for a height of 1 m.
 Example: length of 0.4 m for 1 vertical meter.

■ Dimensions to be provided (mm)

- Length of hood (B) :
 Width of opening (C) :
 Height of opening (D) :
 Overall width (E) :
 Overall height (F) :

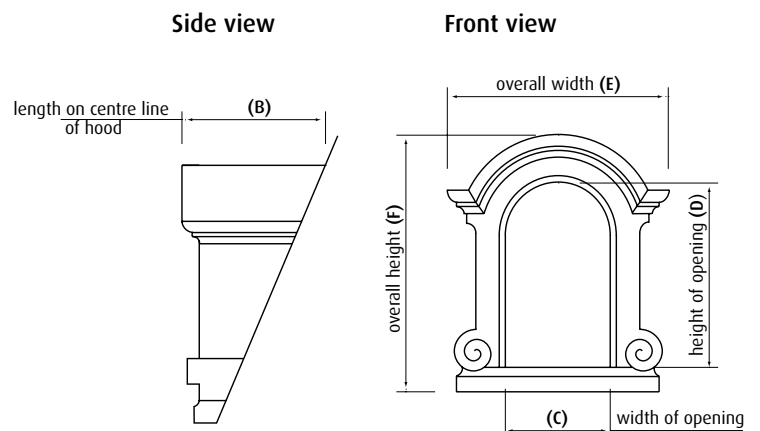

SMOOTH AND STAMPED PROFILES

Decorative profiles were initially designed to ensure watertightness of roof slope junctions and roof break lines, and over time they retained this essential function.

Whether for curb members, hip capping or gutter fronts, profiles can be “straight” formed and decorated with rings or stamped with ovum and gadroon motifs.

When decorated with escutcheons, leaves or rope designs they embellish the roof and facade of the entire building.



Smooth and stamped profiles



Stamped curb member



Curved gutter *



Rue du 4 septembre, Paris, France *



Curb member and rings, Versailles, France *

* Made to order model

Smooth and stamped profiles



Grand Palais, Paris, France *



Grand Palais, Paris, France *

* Made to order model

Straight smooth profiles

Referenced curb members

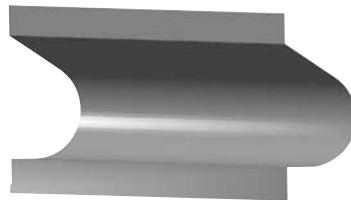

1235

Standard extended widths (in mm)

- 250
- 333
- 400
- 500
- 600
- 650



1236

Standard extended widths (in mm)

- 250
- 333
- 400
- 500
- 600
- 650



Rings

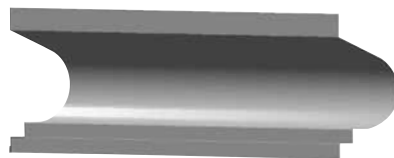

1237

Standard extended widths (in mm)

- 333
- 400
- 500
- 600
- 650



1238

Standard extended widths (in mm)

- 333
- 400
- 500
- 650

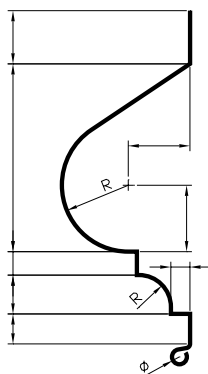

Referenced curb members are available in the extended widths mentioned above. For made to order curb members, please specify:

- type or aspect of metal
- thickness
- extended width
- length
- with or without ring
- with or without relief.

For estimate and production, a ring model, template or sketch with measurements must be provided.

Straight smooth profiles

Referenced gutter fronts



1231

Standard extended widths (in mm)

333
400
500



1232

Standard extended widths (in mm)

333
400
500



1233

Standard extended widths (in mm)

333
400
500

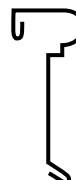

1234

Standard extended widths (in mm)

400
500
650



Rings

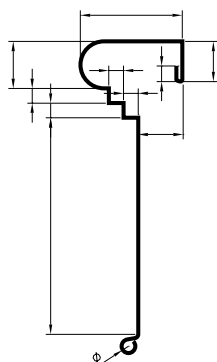
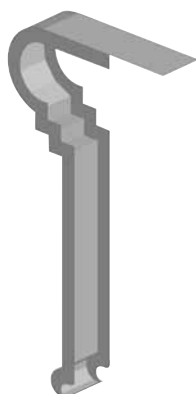

Referenced gutter fronts are available in the extended widths mentioned above. For made to order curb members, please specify:

- type or aspect of metal
- thickness
- extended width
- length
- with or without ring
- with or without relief.

For estimate and production, a ring model, template or sketch with measurements must be provided.

Straight smooth profiles

Referenced cover strips



Standard extended widths (in mm)
200
250

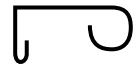

1227

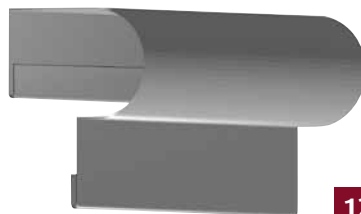

Standard extended widths (in mm)
250
333

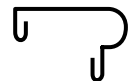

1228

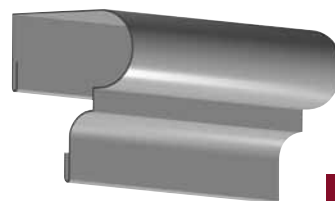

Standard extended widths (in mm)
250
333

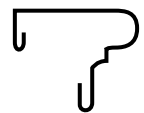

1229

Rings

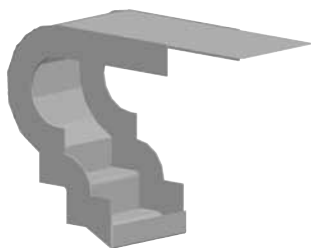

Standard extended widths (in mm)
250
333

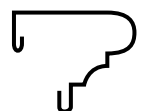

1230

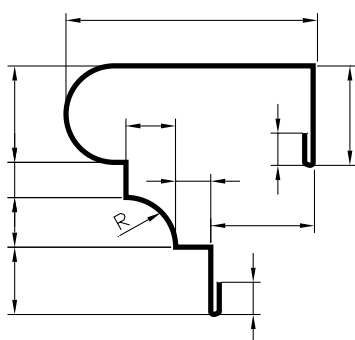

Referenced cover strips are available in the extended widths mentioned above.
For made to order cover strips, please specify:

- type or aspect of metal
- thickness
- extended width
- length
- with or without ring
- with or without relief.

For estimate and production, a ring model, template or sketch with measurements must be provided.

Smooth curved profiles

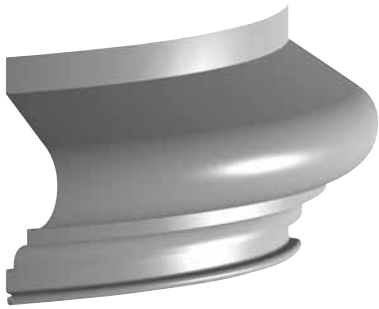

Curb members



Gutter fronts

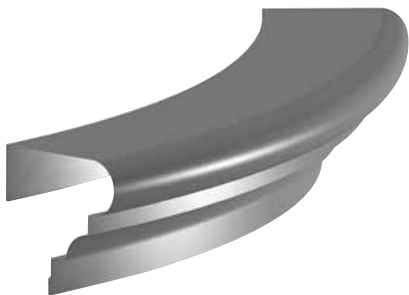

Cover strips



Gutters

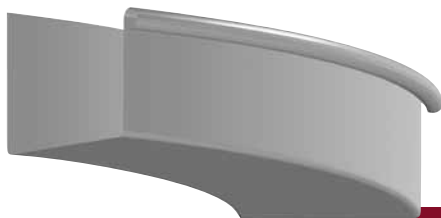

Box gutters

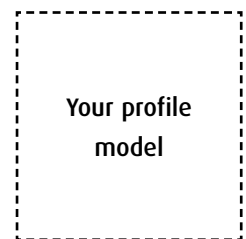

Other curved profiles

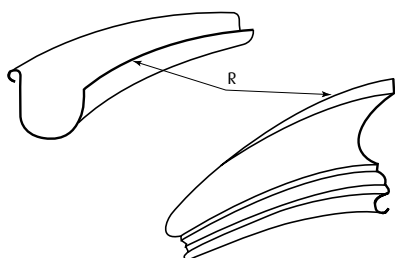

For curved profiles, please specify:

- type or aspect of metal
- extended width
- length
- with or without ring
- the radius R of the curve.

Referenced stamped profiles

Curb members



2257



4244



4251



Reference	Height in cm	Overall length in mm	Depth in mm
2257	21	1005	60
	27	865	90
	33	1020	110
4244	25	980	80
4251	27	995	60

Gutter fronts - Escutcheons



4272

Reference	Height in cm	Overall length in mm	Depth in mm
4272	36	975	33
4273	41	995	70
4395	50	-	90



4273



4395

STAMPED MOTIFS

Stamped ornaments are the core of VMZINC know-how: Our refined and varied range is a market reference. A special alloy is necessary to produce stamped motifs, and it can take up to ten different operations to form a ridge cap, an acanthus leaf, an escutcheon... or a face.

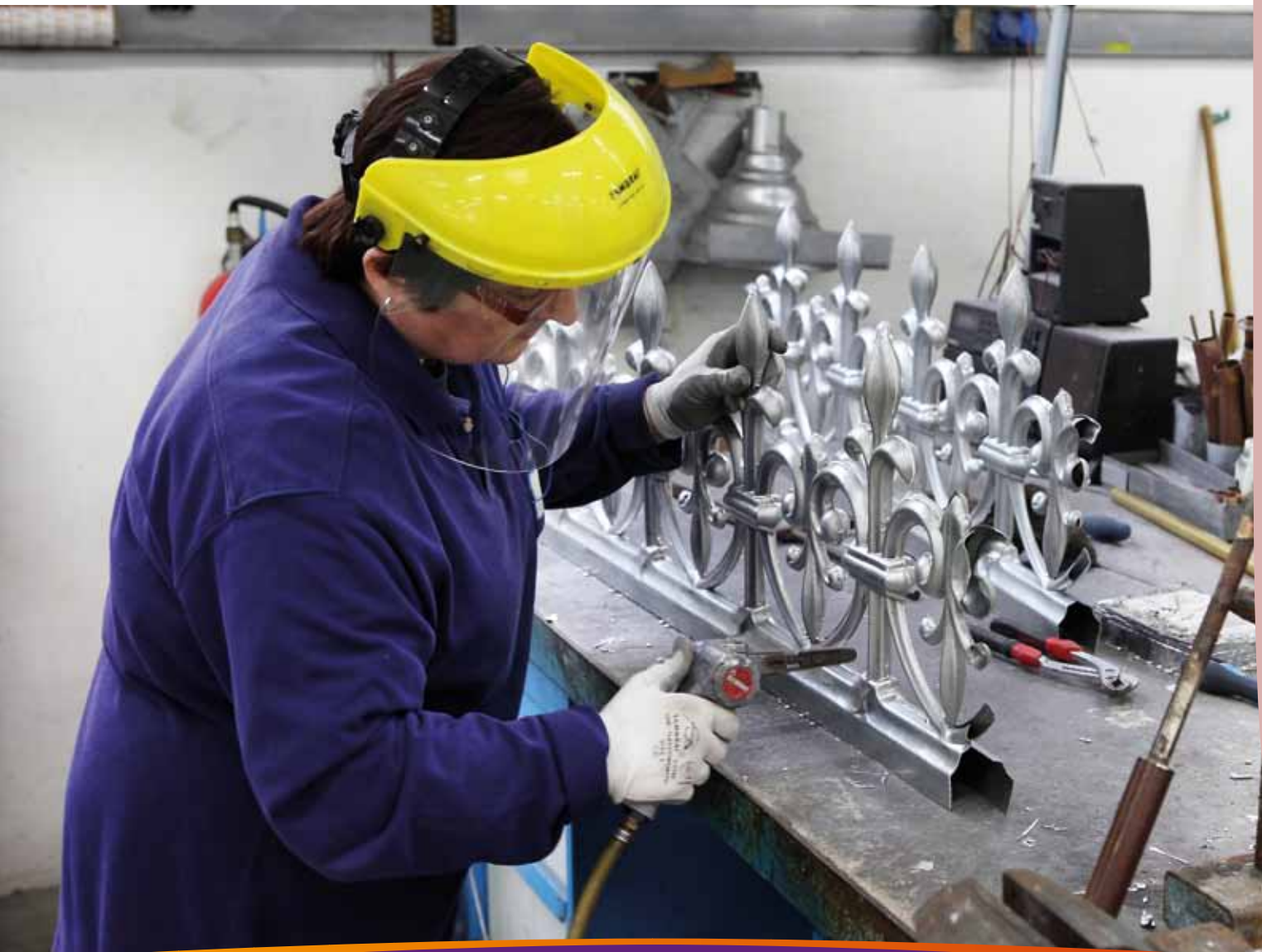

Stamped motifs



Château de Madrid, Neuilly-sur-Seine, France *



Versailles, France *

* Made to order model

Stamped motifs



Theatre, Quimper, France *



The Church of Saint Augustine, Paris, France *



Stamped ridge cap *

* Made to order model

Stamped motifs



Restaurant, Lyon, France *



Versailles, France *

* Made to order model

Stamped motifs



Lion head, escutcheon *



Stamped ridge cap *



Parliament of Brittany, Rennes, France *

* Made to order model



4022

Stamped motifs

Referenced double ridge caps

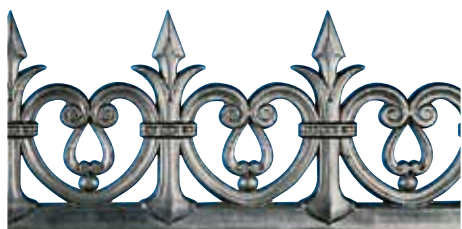

2085

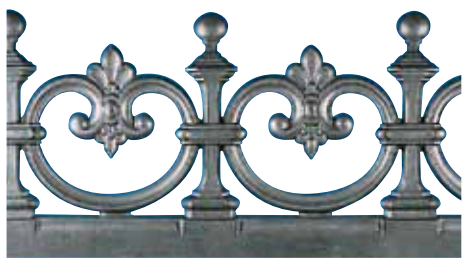

2255



2506



2615

Height (m)	H1	L	B	A	H2	H3	Diameter ** of fixing rod in mm
	Height in mm	Overall length* in mm	Centre distance in mm	Length of overlap in mm	Height of frieze in mm	Height of fixing rod penetration in mm	
2085	270	950	190	95	180	240	12
2255	300	980	245	122.5	260	255	10
2506	400	770	385	192.5	310	383	16
2615	215	960	160	80	150	155	10
	350	960	240	120	240	240	12
2710	380	885	295	147.5	315	370	10
4020	900	960	480	480	500	830	16
4022	700	1140	380	380	420	680	16
4033	500	945	315	157.5	360	480	14
4042	300	960	240	120	175	280	12

* Overall length may vary by +/- 10 mm

** Rod not supplied

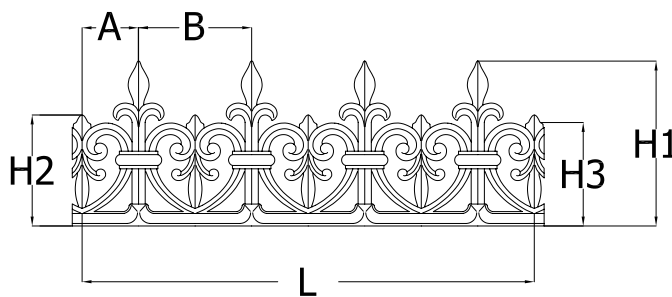

Stamped motifs

Referenced double ridge caps



2710



4042



4020



4033

Galleries



1675



1850



2045



2185



2241



4676

Reference	Height in mm	Overall length* in mm	Centre distance in mm	Height of frieze in mm
1675	150	990	235	115
1850	130	965	160	95
2045	80	950	75	55
2185	140	1040	145	115
2241	120	1060	122	70
4676	180	985	195	100

* Overall length may vary by +/- 10 mm

Referenced stamped motifs

Canopies

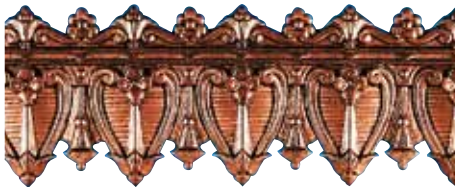

2155

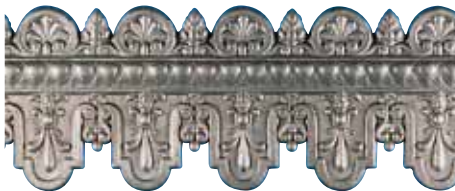

2178

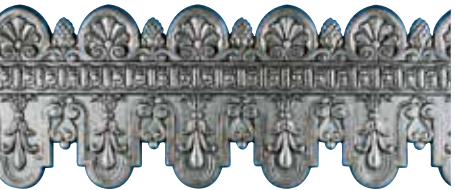

2179

Reference	Height in mm	Overall length in mm	Centre distance in mm	Height of upper frieze in mm	Height of lower frieze in mm
2155	190	1010	110	42	125
2178	220	987	122	130	60
2179	320	953	155	100	165

* Overall length may vary by +/- 10 mm

Scallops



2834



4668

Reference	Height in mm	Overall length in mm	Centre distance in mm	Height of upper frieze in mm	Height of lower frieze in mm
2834	350	1037	122	75	220
4668	400	987	190	-	370

* Overall length may vary by +/- 10 mm

Referenced stamped motifs

Ropes, hip capping and beads



2427



2507



2508

Reference	Height in mm	Overall length* in mm	Depth in mm
2427	130	1060	47
	150	1065	50
	195	1030	
25 07	30	1065	13
	65	910	
	90	1020	
2508	50	1065	15
	70	1005	30

* Overall length may vary by +/- 10 mm

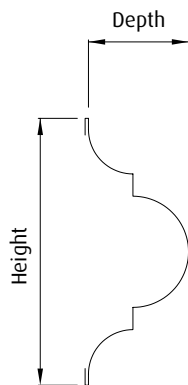

Rosettes



3097



3098



3099



4451

Reference	Diameter in cm
3097	7
	10
3098	18
3099	11
	14
	16
4451	16

OTHER PRODUCTS

Decorative roofing articles and rainwater downpipes.



Other products



Apprentis d'Auteuil foundation, Paris, France



Scale panels - Square Viollet, Paris, France

* Made to order model

Other products



Made to order scale panels, Pau, France *



Made to order scales, Lons-le-Saulnier, France *



Grand Palais, Paris, France: leaves on curved curb member

* Made to order model

Other products

Referenced horizontal scale panels

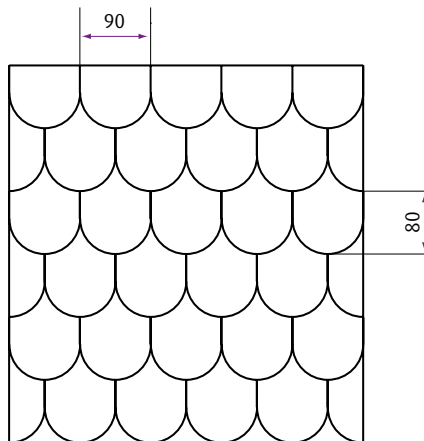
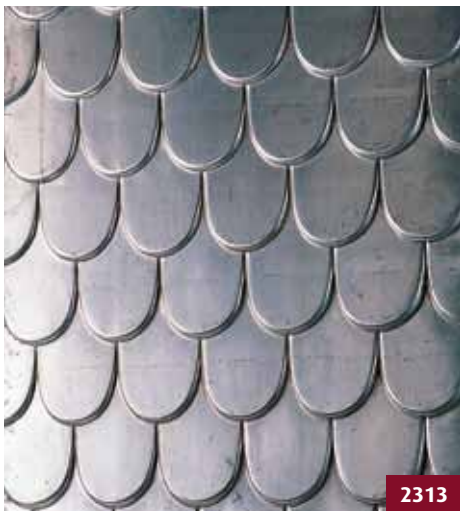
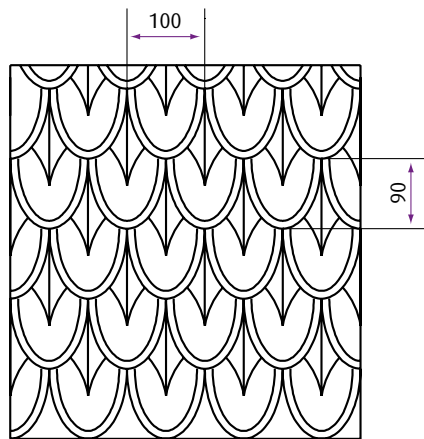

Horizontal

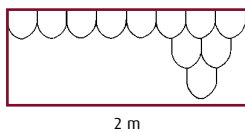

Reference	Height in m	Length in m
1965	0.50	2
2313	0.50	2

Other products

Referenced rainwater downpipes

Decorative pipes



4700



1873

Decorative overflow



2279

Reference	Diameter in mm	Length or height *or section in mm
4700	140 x 90	1000
1873	80	1000
	100	1000
2279	80	285 x 190
	100	295 x 207
2457	80	72° bend
	100	72° bend
2458	80	Dolphin bend
	100	Dolphin bend
2458	80	Offset 110
	100	Offset 185
1148	60	200
2262	40	135
	80	280
	100	300

Ribbed bends



2457

Dolphin bends



2458

Gargoyles



1148



2262

Referenced stamped motifs

Leaves



2270

Reference	Height in cm
2270	72
2280	17
	23
	50



2288

Heads



4329

Reference	Height in cm
4329	23
4333	16



4333

VMZINC

Umicore Building Products France S.A.S.
Les Mercuriales
40 rue Jean Jaurès
93176 Bagnolet Cedex - FRANCE

Information
Tel.: +33 1 49 72 43 40
www.vmzinc.com
vmzinc.ornements@umicore.com

